

INSTRUCTION

INTRODUCTION

This is a Touch panel controller is a new high-end controller which newly developed. It adopts glass panel design, is beautiful and fashionable in appearance. It adopts high precision capacitance touch control chip, increases the touch sensitivity, reduces trigger which caused by mistake. It is used for controlling a variety of constant voltage led light. Such as LED point source, flexible led strip, panel lights etc., it has many advantages such as convenient to connect, easy to use and others.

SPECIFICATION

- Working temperature: -20-60 °C
- Supply voltage: DC12~24V



1. DIM SPECIFICATION

- supply voltage: DC12~24V
- connection mode: common anode
- net weight: 126g
- output current: <math>< 4A/CH</math>

- output: 3 channels
- size: L86 x W86 x H36 mm
- static power consumption: <math>< 1W</math>
- output power: 12V<math>< 144W</math>, 24V<math>< 288W</math>

FUNCTION

- Static color: single color
- Brightness: 1%~100%
- DIY: Can save 2 kinds of brightness as you want
- 20 seconds delay off
- Dynamic modes: 1. Fade 2. Fade+ Flash 3 times 3. Strobe 4. Flash 5. Auto-cycle

CONTROL METHOD

- Touch this button to turn on/off
- Touch the ring to adjust brightness
- Touch this button for brightness select (1%-50%-100%)
- Touch this button for 20 seconds delay off
- Touch this button for dynamic modes select
- Touch this button for dynamic mode Speed change
- Touch and hold this button to save brightness as you want.
- Touch this button to select the brightness you saved

TOUCH PANEL GUIDANCE

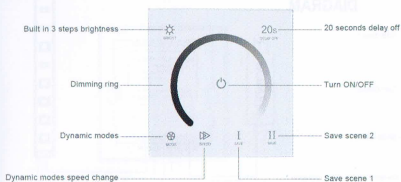

DIAGRAM

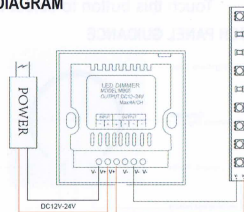

2. CCT SPECIFICATION

- supply voltage: DC12~24V
- connection mode: common anode
- net weight: 126g
- output current: <math>< 6A/CH</math>

- output: 2 channels
- size: L86 x W86 x H36 mm
- static power consumption: <math>< 1W</math>
- output power: 12V<math>< 144W</math>, 24V<math>< 288W</math>

FUNCTION

- Static color: Warm white to cool white range
- Brightness: 1%~100%
- DIY: Can save 2 kinds of color temperature & brightness as you want
- Dynamic modes: 1. Warm white fade 2. Cool white fade 3. Warm & Cool white cross fade 4. Warm white strobe 5. Cool white strobe 6. Warm & Cool white cross Strobe 7. Auto-cycle

CONTROL METHOD

- Touch this button to turn on/off
- Touch the ring to adjust brightness in DIM situation, adjust color temperature in CT situation
- Touch this button for DIM situation
- Touch this button for CT situation
- Touch this button for dynamic modes select
- Touch this button for dynamic mode Speed change
- Touch and hold this button to save brightness as you want.
- Touch this button to select the brightness you saved

TOUCH PANEL GUIDANCE

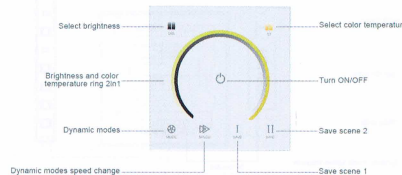

DIAGRAM

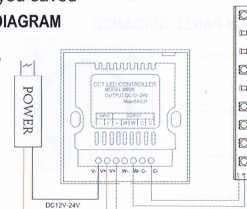

3. RGB

SPECIFICATION









- supply voltage: DC12~24V
- connection mode: common anode
- net weight: 126g
- output current: <4A/CH

- output: 3 channels
- size: L86 x W86 x H36 mm
- static power consumption: <1W
- output power: 12V<144W, 24V<288W

FUNCTION

- Static color: 16 million colors with color ring
- Brightness: 1%~100%
- White: Mix white (Red, Green, Blue light on together)
- Dynamic modes: 1. RGB Strobe 2. RGB Fade 3. 7 Colors Strobe 4. 7 Colors Flash 5. 7 Colors Fade in & out 6. 7 colors Fade 7. White Fade in & out 8. Red Fade in & out + flash 3 times 9. Green Fade in & out + flash 3 times 10. Blue Fade in & out + flash 3 times 11. White Fade in & out + flash 3 times 12. Auto-cycle.

CONTROL METHOD

-  · Touch this button to turn on/off
-  · Touch the ring to adjust brightness in DIM situation, adjust color in RGB situation
-  · Touch this button for DIM situation
-  · Touch this button for RGB situation
-  · Touch this button for dynamic modes select
-  · Touch this button for dynamic mode speed reduce
-  · Touch this button for dynamic mode Speed increase
-  · Touch this button to select white color

TOUCH PANEL GUIDANCE

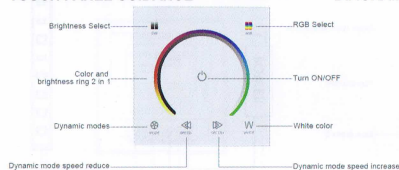

DIAGRAM

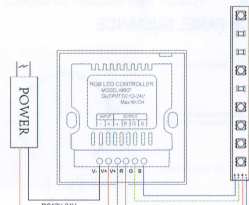

4. RGBW

SPECIFICATION









- supply voltage: DC12~24V
- connection mode: common anode
- net weight: 126g
- output current: <4A/CH

- output: 4 channels
- size: L86 x W86 x H36 mm
- static power consumption: <1W
- output power: 12V<192W, 24V<384W

FUNCTION

- Static color: 16 million colors with color ring
- Brightness: 1%~100%
- White: W white
- Dynamic modes: 1. RGB Strobe 2. RGB Fade 3. 7 Colors Strobe 4. 7 Colors Flash 5. 7 Colors Fade in & out 6. 7 colors Fade 7. White Fade in & out 8. Red Fade in & out + flash 3 times 9. Green Fade in & out + flash 3 times 10. Blue Fade in & out + flash 3 times 11. White Fade in & out + flash 3 times 12. Auto-cycle.

CONTROL METHOD

-  · Touch this button to turn on/off
-  · Touch the ring to adjust brightness in DIM situation, adjust color in RGB situation
-  · Touch this button for DIM situation
-  · Touch this button for RGB situation
-  · Touch this button for dynamic modes select
-  · Touch this button for dynamic mode speed reduce
-  · Touch this button for dynamic mode Speed increase
-  · Touch this button to select white color

TOUCH PANEL GUIDANCE

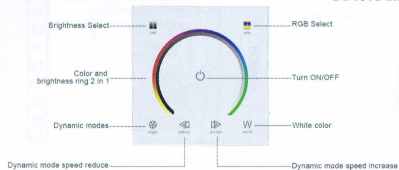

DIAGRAM

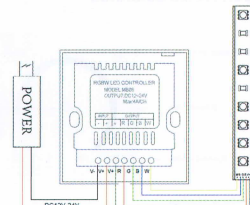

INSTALLATION

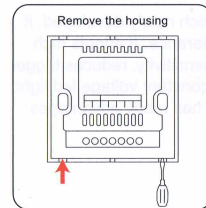

Step 1

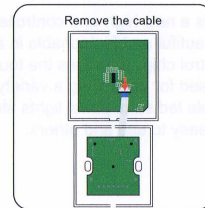

Step 2

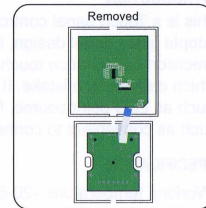

Step 3

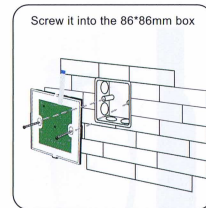

Step 4

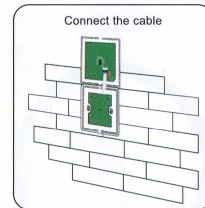

Step 5

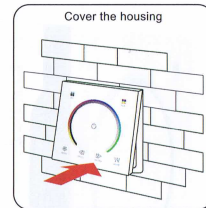

Step 6

